

GENERAL NOTES
 Use Marked dimensions where shown in preference to scaling
 No accuracy can be guaranteed due to printing variations
 Site measurements should be taken to ensure accuracy
 Check Dimensions prior to construction or offsite fabrication
 New work or any existing work affected is shown hatched on drawings
 This drawing to be read in conjunction with Structural Engineer's Calculations
 Please inform Architect or Drawing Originator of any discrepancy immediately

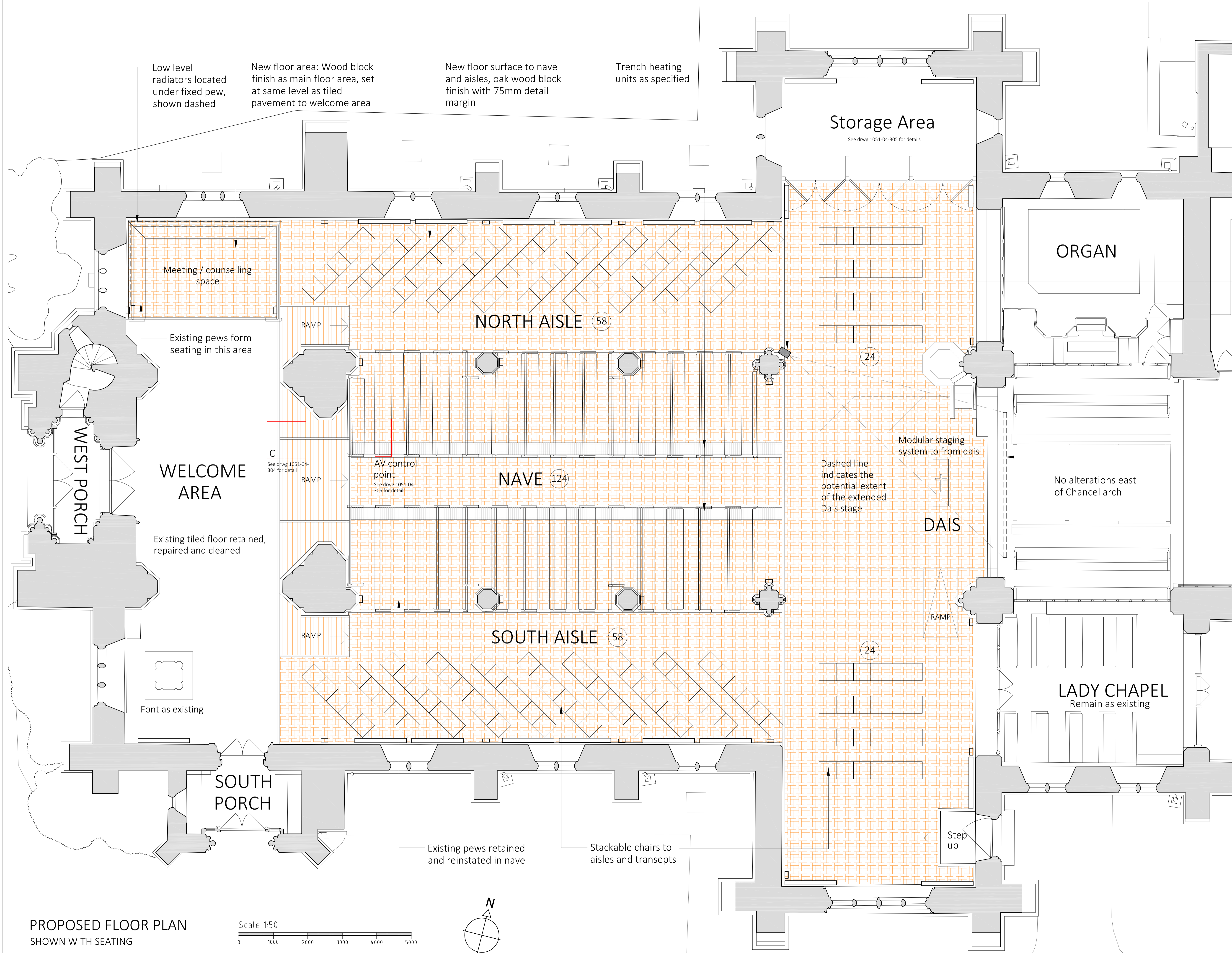

- KEY**
- Electrical socket outlets sit flush with floor
 - Number of seats. Note: seating within the Nave is approx.
Approx seating total = 288
 - Indicative position of new radiators

Data projector bracket fixed to pier.

Location of drop-down AV screen concealed behind Chancel arch, shown dashed.

B- Timber boarded flooring amended to Wood block flooring. 09/11/16
 A- Indicative position of new radiators indicated on plan. 16/09/16

CHRIST CHURCH SWINDON

RE-ORDERING & ALTERATIONS

INTERIOR WORKS PROPOSED FLOOR PLAN

Dwg no. **1051-04-302** Rev. **B**

ST ANN'S GATE ARCHITECTS LLP
 The Close . Salisbury . SP1 2EB
 Tel: 01722 555200
 Fax: 01722 555201
 e: admin@stannsgate.com
 w: www.stannsgate.com



Scale: **1:50 @ A1 (1:100 @ A3)**

Date: **AUG 2016** Drawn: **AFK/CL**

© This drawing may not be reproduced without the prior knowledge and consent of St Ann's Gate Architects LLP

PROPOSED FLOOR PLAN
 SHOWN WITH SEATING

